

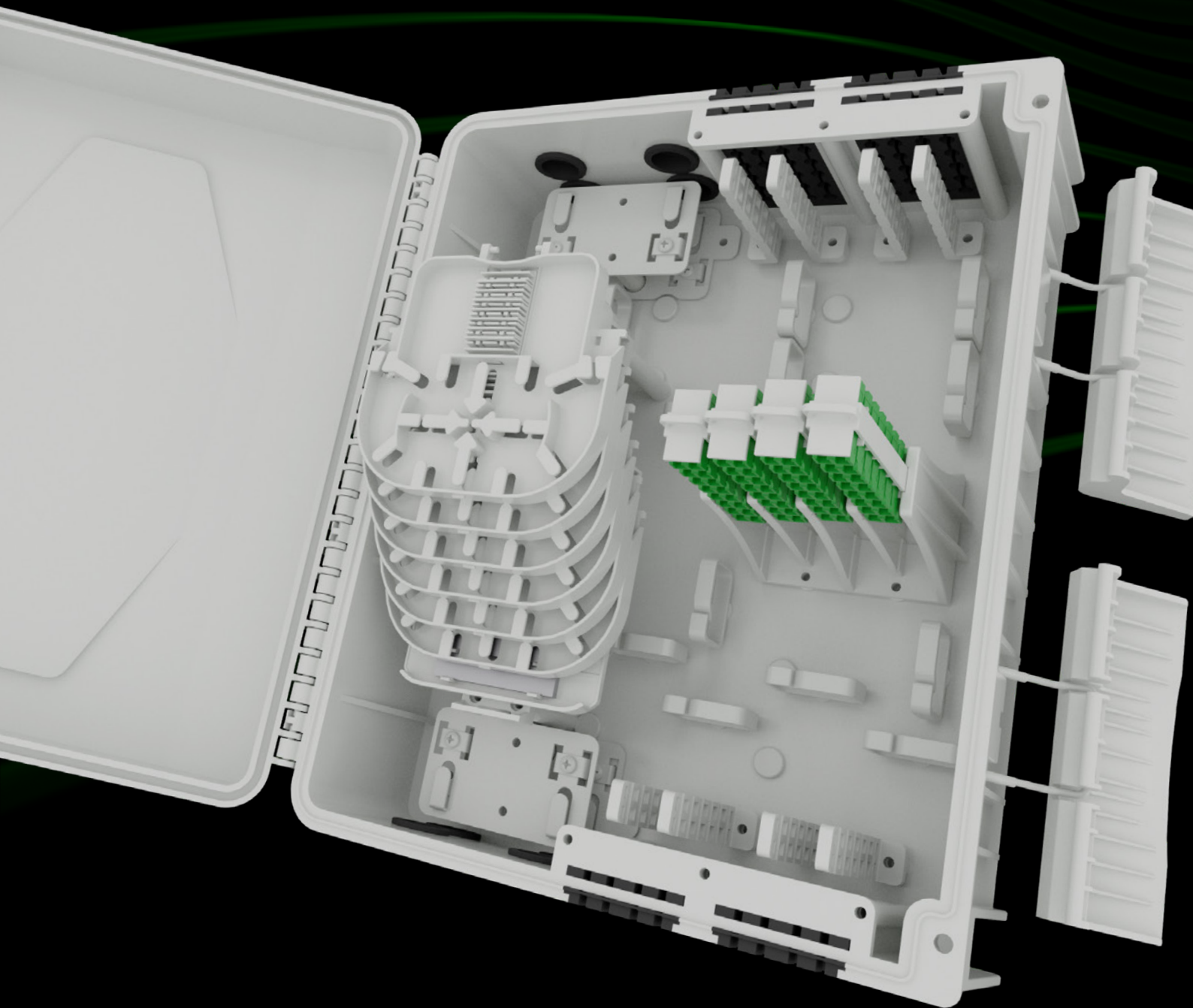

# Encasa

## 48 Fibre Distribution Point



## ENCASA 48 FIBRE DISTRIBUTION POINT

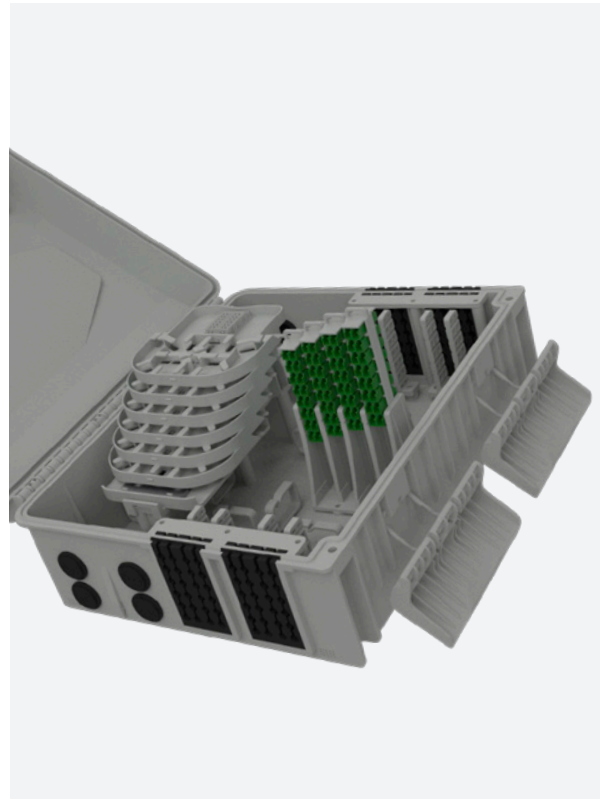

### PRODUCT OVERVIEW

The Encasa range of fibre distribution points have been designed to fit within the FTTx network. These enclosures can be aerial, or wall mounted. Made from 100% virgin UL94-V0 rated material, UV stable and are IP56 rated, allowing them to be used in both internal and external applications.

This Encasa fibre distribution point accommodates 48 fibres (using LC connections) or 32 fibres (using SC connections). Flexibility is increased through the option to use the enclosure for traditional splicing of cables with a capacity of 144 fibres and the installation of pre-terminated cables via the 96 split gland cable exit points 48 on the top and bottom of the enclosure that accept both flat and round cable.

The use of splitters is also possible with mounting positions for up to 12 units found under the splice trays.

Each enclosure comes pre-loaded with APC adaptors and splitters. The splitters are terminated with APC connections on the outgoing end and unterminated on the incoming end as standard. Options are available to have adaptors and standard pigtails or loaded with adaptors only.

The adaptor field has been designed so each stack of adaptors can be pulled up to allow better access to plug and unplug connections.

The cable entry points allow for midspan cable installation and for cable to be passed through to feed further enclosures in the network.

Integrated fibre management allows 250µm and 900µm fibre to be installed, keeping the fibres safe and always maintaining the required bend radius.

## PRODUCT FEATURES

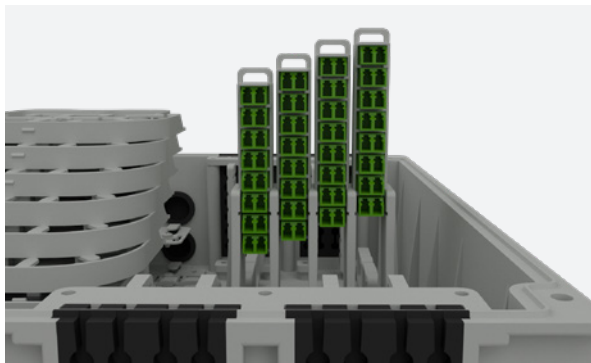

Adaptor Field

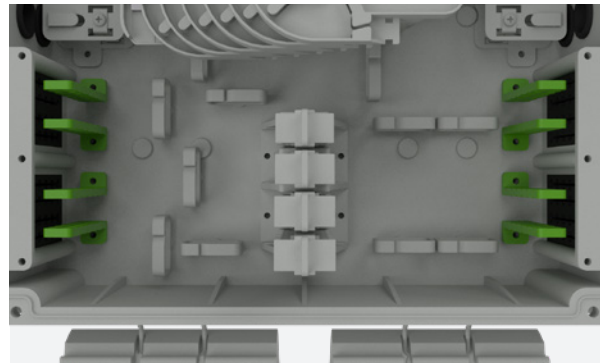

Cable Tie Points

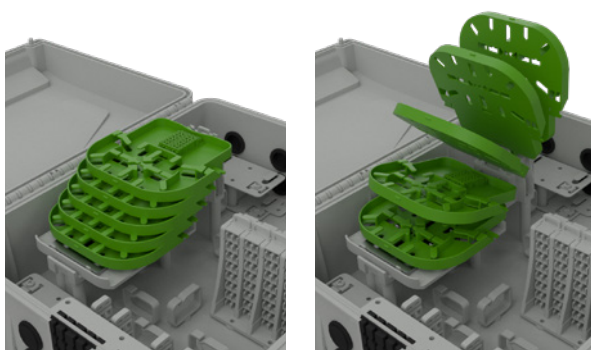

Splice Trays

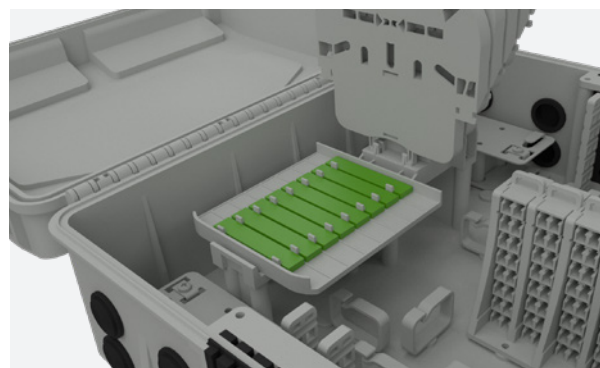

Splitter Area

## GENERAL

|                                     |   |
|-------------------------------------|---|
| Maximum number of fibres            | 32 SC or 48 LC  |
| Maximum number of splice trays      | 6   |
| Maximum number of fibres per tray   | 24  |
| Maximum number of splices           | 144   |
| Adaptor type                        | SC Simplex/LC Duplex  |
| Maximum number of adaptor positions | 32  |
| IP rating                           | IP56 - suitable for internal and external installations                             |
| UV stable                           | Yes   |
| Material                            | ABS+PC  |
| UL94-V0                             | Yes   |
| Colour                              | Light grey (RAL 7035) or black (RAL 9005)<br>Other colours available subject to MOQ |
| Dimensions (mm)                     | 368mm H x 295mm W x 130mm D   |

## SPLITTER OPTIONS

|                   |               |
|-------------------|---------------|
| 1:4 plc splitter  | Maximum of 12 |
| 1:8 plc splitter  | Maximum of 6  |
| 1:16 plc splitter | Maximum of 3  |

## CABLE ENTRY AND EXIT PARAMETERS

|  |                      |
|--|----------------------|
| Number of feeder cable entry points    | 4 top and 4 bottom   |
| Midspan capability                     | Yes                  |
| Cable diameter using compression gland | 5mm – 13.5mm         |
| Cable diameter using rubber grommet    | 5mm – 20mm           |
| Number of cable exit points            | 48 top and 48 bottom |
| Cable diameter                         | 3mm – 6mm            |

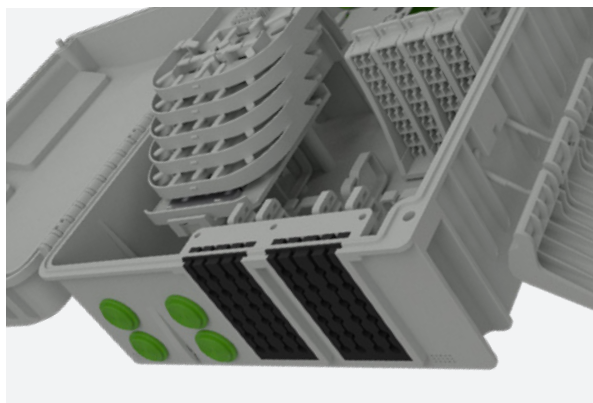

Cable Entry Points

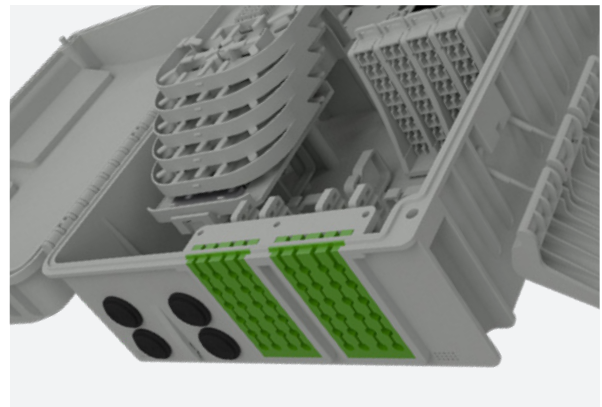

Cable Exit Points

## LC AND SC APC ADAPTOR SPECIFICATION

|                           |                       |
|---------------------------|-----------------------|
| Insertion loss            | < 0.2 dB              |
| Durability (500 mating)   | < 0.2 dB max increase |
| Operating temperature     | -40°C to 80°C         |
| Retention force           | 200 - 600 grams       |
| Alignment sleeve material | Ceramic               |
| Flammability rated        | UL94-V0               |
| Polish type               | APC                   |

## SPLITTER SPECIFICATION

|   | 1x4             | 1x8  | 1x16 |
|---|-----------------|------|------|
| Operating wavelength                        | 1260 to 1650 nm |      |      |
| Fibre type                                  | G657A2          |      |      |
| Temperature stability (dB) at -40°C to 85°C | ≤0.4            | ≤0.4 | ≤0.5 |
| Storage temperature                         | -40°C to 85°C   |      |      |
| Return loss                                 | ≥55dB           |      |      |

## DIMENSIONS

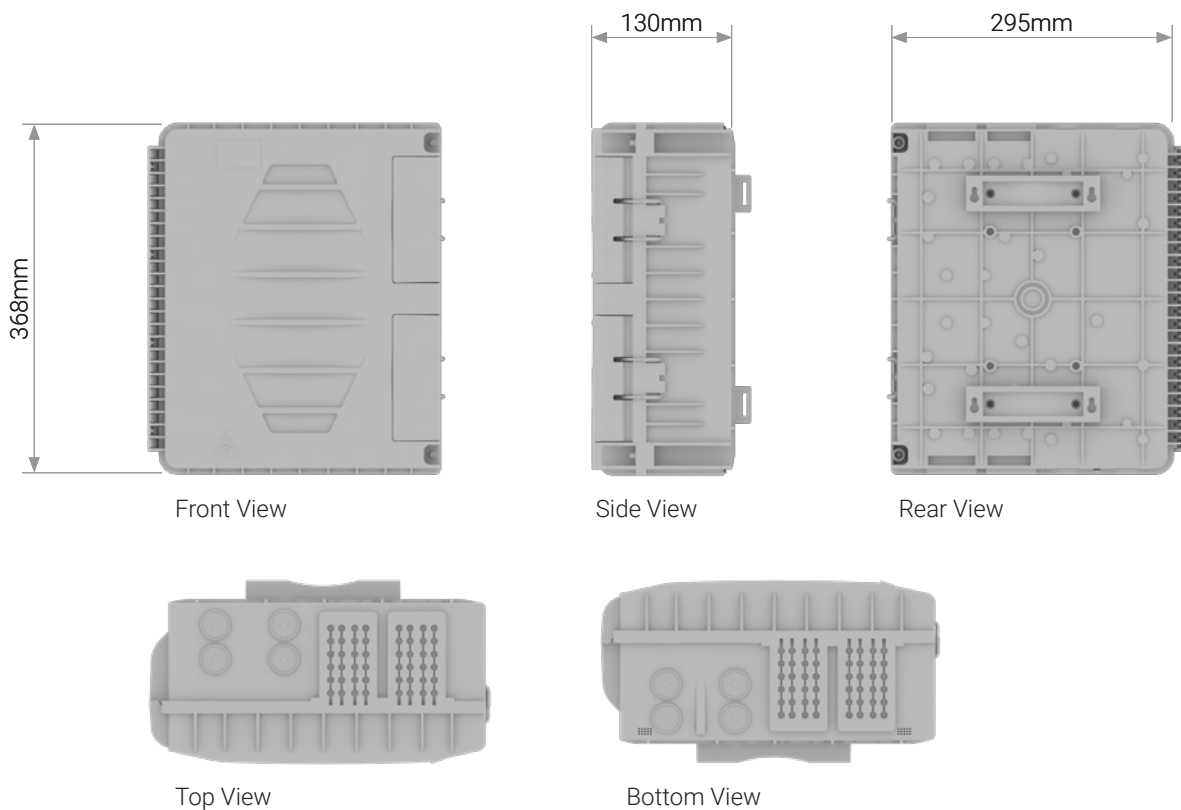

## PART NUMBER INFORMATION

| Part Number | Product Description  |
|-------------|--|
| 948-000     | Encasa 48 fibre distribution point loaded with 32 x LCA adaptors + 8 x 1:4 splitters grey  |
| 948-001     | Encasa 48 fibre distribution point loaded with 48 x LCA adaptors + 12 x 1:4 splitters grey |
| 948-002     | Encasa 48 fibre distribution point loaded with 32 x LCA adaptors + 4 x 1:8 splitters grey  |
| 948-003     | Encasa 48 fibre distribution point loaded with 48 x LCA adaptors + 6 x 1:8 splitters grey  |
| 948-004     | Encasa 48 fibre distribution point loaded with 32 x LCA adaptors + 2 x 1:16 splitters grey |
| 948-005     | Encasa 48 fibre distribution point loaded with 48 x LCA adaptors + 3 x 1:16 splitters grey |
| 948-006     | Encasa 48 fibre distribution point loaded with 32 x LCA adaptors + 1 x 1:32 splitter grey  |
| 948-007     | Encasa 48 fibre distribution point loaded with 32 x SCA adaptors + 4 x 1:8 splitters grey  |

Design registration and patent pending.



Excel House, Junction Six Industrial Park  
Electric Avenue, Birmingham, B6 7JJ

Phone: 0800 75 75 65  
Email: [FTTx@mayflex.com](mailto:FTTx@mayflex.com)

[www.excel-networking.com](http://www.excel-networking.com)

## ENCASA PRODUCT RANGE

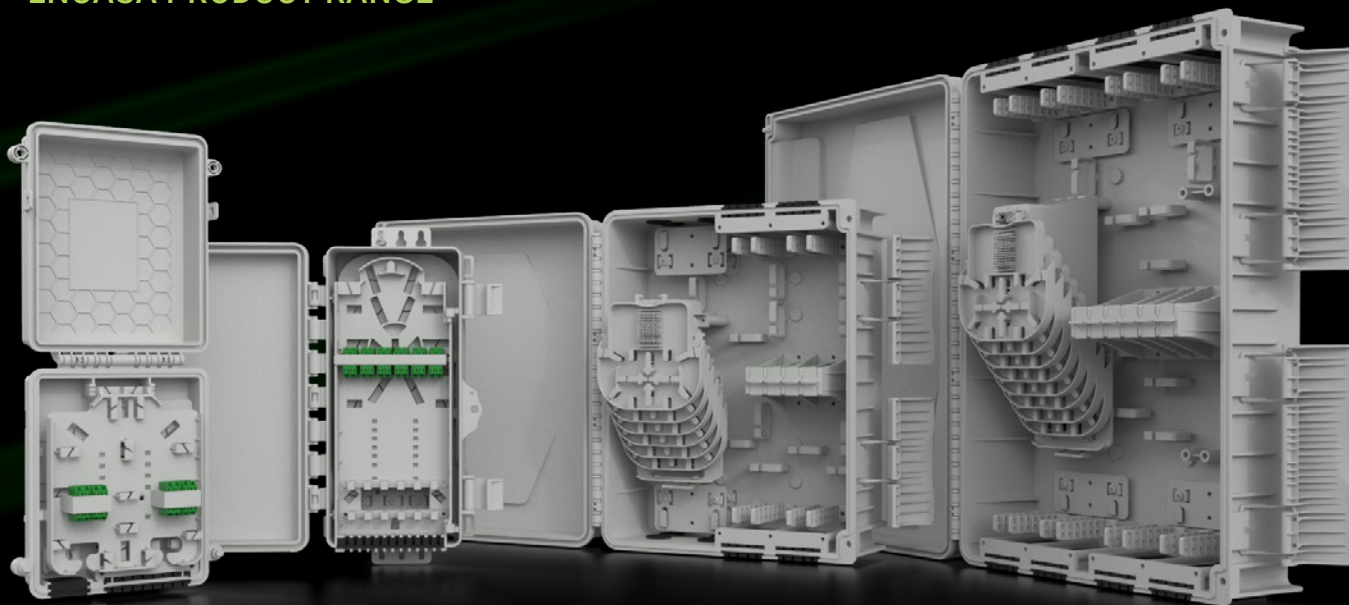

The Encasa range from Excel provides flexible, easy to use enclosures with a range of connection options and capacities, complemented by fast to install pre-connectorised cables.